

**PARTICULARS TO APPEAR ON THE OUTER PACKAGE {Cardboard box}**

**1. NAME OF THE VETERINARY MEDICINAL PRODUCT**

Tralieve 80 mg chewable tablets

**2. STATEMENT OF ACTIVE SUBSTANCES**

Each tablet contains:

Tramadol 70.3 mg  
(equivalent to 80 mg Tramadol hydrochloride)

**3. PACKAGE SIZE**

10 tablets  
20 tablets  
30 tablets  
40 tablets  
50 tablets  
60 tablets  
70 tablets  
80 tablets  
90 tablets  
100 tablets  
250 tablets

**4. TARGET SPECIES**

Dogs.



**5. INDICATIONS**

**6. ROUTES OF ADMINISTRATION**

For oral use

## **7. WITHDRAWAL PERIODS**

## **8. EXPIRY DATE**

Exp. {mm/yyyy}

Shelf life of divided tablets: 3 days.

## **9. SPECIAL STORAGE PRECAUTIONS**

Do not store above 30°C.

Store in the original package in order to protect from moisture.

## **10. THE WORDS “READ THE PACKAGE LEAFLET BEFORE USE”**

Accidental ingestion of this product may be harmful. To avoid accidental ingestion, particularly by a child, unused tablet parts should be returned to the open blister space and inserted back into the carton and kept in a safe place out of the sight and reach of children as they pose a health risk to small children due to accidental ingestion.

Read the package leaflet before use.

## **11. THE WORDS “FOR ANIMAL TREATMENT ONLY”**

For animal treatment only.

## **12. THE WORDS “KEEP OUT OF THE SIGHT AND REACH OF CHILDREN”**

Keep out of the sight and reach of children.

## **13. NAME OF THE MARKETING AUTHORISATION HOLDER**

Dechra Regulatory B.V

## **14. MARKETING AUTHORISATION NUMBERS**

Vm 50406/5011

## **15. BATCH NUMBER**

Lot {number}

**MINIMUM PARTICULARS TO APPEAR ON SMALL IMMEDIATE PACKAGING  
UNITS {Aluminium-PVC/PE/PVDC blisters}**

**1. NAME OF THE VETERINARY MEDICINAL PRODUCT**

Tralieve



**2. QUANTITATIVE PARTICULARS OF THE ACTIVE SUBSTANCES**

Tramadol hydrochloride            80 mg/tablet

**3. BATCH NUMBER**

Lot {number}

**4. EXPIRY DATE**

<Exp. {mm/yyyy}>

## **PARTICULARS TO APPEAR ON THE PACKAGE LEAFLET:**

### **PACKAGE LEAFLET**

#### **1. Name of the veterinary medicinal product**

Tralieve 80 mg chewable tablets for dogs

#### **2. Composition**

Each tablet contains:

##### **Active substance:**

Tramadol 70.3 mg  
(equivalent to 80 mg Tramadol hydrochloride)

Light brown with brown spots, round and convex flavoured 11 mm tablet with a cross-shaped break line on one side.

Tablets can be divided into 2 or 4 equal parts.

#### **3. Target species**

Dogs.

#### **4. Indications for use**

For the reduction of acute and chronic mild soft tissue and musculoskeletal pain.

#### **5. Contraindications**

Do not administer in conjunction with tricyclic antidepressants, monoamine oxidase inhibitors and serotonin reuptake inhibitors.

Do not use in case of hypersensitivity to tramadol or to any of the excipients.

Do not use in animals with epilepsy.

#### **6. Special warnings**

##### Special warnings:

The analgesic effects of tramadol hydrochloride may be variable. This is thought to be due to individual differences in the metabolism of the drug to the primary active metabolite O-desmethyltramadol. In some dogs (non-responders) this may result in the veterinary medicinal product failing to provide analgesia. For chronic pain, multimodal analgesia should be considered. Dogs should be monitored regularly by a veterinarian to ensure adequate pain relief. In case of recurrence of pain or insufficient analgesia the analgesic protocol may need to be reconsidered.

Special precautions for safe use in the target species:

Use with caution in dogs with renal or hepatic impairment. In dogs with hepatic impairment the metabolism of tramadol to the active metabolites may be decreased which may reduce the efficacy of the veterinary medicinal product. One of the active metabolites of tramadol is renally excreted and therefore in dogs with renal impairment the dosing regimen used may need to be adjusted. Renal and hepatic function should be monitored when using this veterinary medicinal product. Cessation of long-term analgesic therapy should be done gradually whenever possible.

Special precautions to be taken by the person administering the veterinary medicinal product to animals:

People with known hypersensitivity to tramadol or any of the excipients should avoid contact with the veterinary medicinal product.

Tramadol may cause sedation, nausea and dizziness after accidental ingestion, especially by children. To avoid accidental ingestion, particularly by a child, unused tablet parts should be returned to the open blister space and inserted back into the carton and kept in a safe place out of the sight and reach of children as they pose a health risk to small children due to accidental ingestion. In case of accidental ingestion, particularly by children, seek medical advice and show the package leaflet or the label to the physician. In case of accidental ingestion by adults: DO NOT DRIVE as sedation may occur.

Wash hands after use.

Pregnancy:

Laboratory studies in mice and/or rats and rabbits have not produced any evidence of teratogenic (malformations of the unborn offspring), foetotoxic (toxic for the unborn offspring), maternotoxic (toxic for the mother) effects. Use only according to the benefit-risk assessment by the responsible veterinarian.

Lactation:

Laboratory studies in mice and/or rats and rabbits have not produced any evidence of adverse effects in the peri- and postnatal development of offspring. Use only according to the benefit-risk assessment by the responsible veterinarian.

Fertility:

In laboratory studies in mice and/or rats and rabbits, the use of tramadol at therapeutic doses did not adversely affect reproductive performance and fertility in males and females. Use only according to the benefit-risk assessment by the responsible veterinarian.

Interaction with other medicinal products and other forms of interaction:

Concomitant administration of the veterinary medicinal product with central nervous system depressants, may potentiate the CNS and respiratory depressant effects.

Tramadol can increase the effect of drugs that lower the seizure threshold.

Drugs that inhibit (e.g. cimetidine and erythromycin) or induce (e.g. carbamazepine) CYP450 mediated metabolism may have an effect on the analgesic effect of tramadol. The clinical relevance of these interactions has not been studied in dogs.

The combination with mixed agonist/antagonists (e.g. buprenorphine, butorphanol) and tramadol is not advisable, because the analgesic effect of a pure agonist may be theoretically reduced in such circumstances.

See also section “*Contraindications*”.

**Overdose:**

In cases of intoxication with tramadol symptoms similar to those observed with other centrally acting analgesics (opioids) are likely to occur. These include in particular miosis, vomiting, cardiovascular collapse, consciousness disorders up to coma, convulsions and respiratory depression up to respiratory arrest.

General emergency measures: Maintain a patent airway, support cardiac and respiratory function depending on the symptoms. Inducing vomiting in order to empty the stomach is suitable unless the affected animal is showing reduced consciousness, in which case gastric lavage may be considered. The antidote for respiratory depression is naloxone. However, naloxone may not be useful in all cases of tramadol overdose as it may only partially reverse some of the other effects of tramadol. In case of seizures, administer diazepam.

**7. Adverse events**

Dogs:

Common (1 to 10 animals / 100 animals treated):	Sedation <sup>a,b</sup> , Drowsiness <sup>b</sup>
Uncommon (1 to 10 animals / 1,000 animals treated):	Nausea, Vomiting
Rare (1 to 10 animals / 10,000 animals treated):	Hypersensitivity reaction <sup>c</sup>
Very rare (<1 animal / 10,000 animals treated, including isolated reports):	Convulsion <sup>d</sup>

<sup>a</sup> Mild.

<sup>b</sup> Especially when higher doses are given.

<sup>c</sup> The treatment should be discontinued.

<sup>d</sup> In dogs with a low seizures threshold.

Reporting adverse events is important. It allows continuous safety monitoring of a product. If you notice any side effects, even those not already listed in this package leaflet, or you think that the medicine has not worked, please contact, in the first instance, your veterinarian. You can also report any adverse events to the marketing authorisation holder or the local representative of the marketing authorisation holder using the contact details at the end of this leaflet, or via your national reporting system at:

Website: <https://www.gov.uk/report-veterinary-medicine-problem/animal-reacts-medicine>

e-mail: [adverse.events@vmd.gov.uk](mailto:adverse.events@vmd.gov.uk)

## 8. Dosage for each species, routes and method of administration

For oral use.

The recommended dose is 2-4 mg tramadol hydrochloride per kg body weight every 8 hours or as needed based on the intensity of pain.

Minimum dosing interval is 6 hours. The recommended maximum daily dose is 16 mg/kg. As the individual response to tramadol is variable and depends partly on the dosage, the age of the patient, individual differences in pain sensitivity and general condition, the optimal dosing regimen should be individually tailored using the above dose and re-treatment interval ranges. The dog should be examined regularly by a veterinarian to assess if additional analgesia is subsequently required. Additional analgesia can be administered by increasing the tramadol dose until the maximum daily dose is reached, and/or by following a multimodal analgesic approach with the addition of other suitable analgesics.

The most appropriate tablet strengths should be used in order to minimise divided tablets to be kept until the next dosing.

Please note that this dosing table is intended as a guide for dispensing the veterinary medicinal product at the high end of the dose range: 4 mg/kg bodyweight. It states the number of tablets required to administer 4 mg tramadol hydrochloride per kg bodyweight.

Body weight	Tramadol 80 mg
20 kg	⊕
30 kg	⊕ ⊔
40 kg	⊕ ⊕
50 kg	⊕ ⊕ ⊔
60 kg	⊕ ⊕ ⊕

⊔ = ¼ Tablet    ⊔ = ½ Tablet    ⊕ = ¾ Tablet    ⊕ = 1 Tablet

## 9. Advice on correct administration

Tablets can be divided into 2 or 4 equal parts to ensure accurate dosing. Place the tablet on a flat surface, with its scored side facing up and the convex (rounded) side facing the surface.

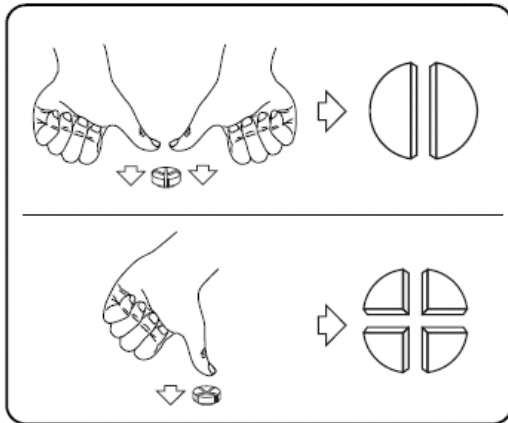

2 equal parts: press down with your thumbs on both sides of the tablet.  
4 equal parts: press down with your thumb in the middle of the tablet.

## **10. Withdrawal periods**

Not applicable

## **11. Special storage precautions**

Keep out of the sight and reach of children.

Shelf life of divided tablets after first opening the immediate packaging: 3 days.

Do not store above 30 °C.

Store in the original package in order to protect from moisture.

Do not use this veterinary medicinal product after the expiry date which is stated on the carton after Exp.

The expiry date refers to the last day of that month.

## **12. Special precautions for disposal**

Medicines should not be disposed of via wastewater.

Use take-back schemes for the disposal of any unused veterinary medicinal product or waste materials derived thereof in accordance with local requirements and with any applicable national collection systems. These measures should help to protect the environment.

Ask your veterinary surgeon or pharmacist how to dispose of medicines no longer required.

## **13. Classification of veterinary medicinal products**

Veterinary medicinal product subject to prescription.



## 14. MARKETING AUTHORISATION NUMBERS AND PACK SIZES

Vm 50406/5011

Pack sizes:

Cardboard box of 1, 2, 3, 4, 5, 6, 7, 8, 9, 10 or 25 blisters of 10 tablets.

Cardboard box containing 10 separate cardboard boxes, each containing 3 blisters of 10 tablets.

Not all pack sizes may be marketed.

## 15. PID LINK (Do not print heading)

*[The following statement must be included where reference to the European Union Product Database is included on the product information. This statement is relevant to both UK(GB) and UK(NI) products:]*

Find more product information by searching for the 'Product Information Database' on [www.gov.uk](http://www.gov.uk).

## 16. Contact details

Marketing authorisation holder <and manufacturer responsible for batch release>:

Dechra Regulatory B.V.

Wilgenweg 7

3421 TV Oudewater

The Netherlands

Manufacturer responsible for batch release:

Lelypharma B.V.

Zuiveringweg 42

8243 PZ Lelystad

The Netherlands

Genera d.d.

Svetonedeljska cesta 2

10436 Rakov Potok

Croatia

Local representatives and contact details to report suspected adverse reactions

Dechra Veterinary Products Limited

Sansaw Business Park

Hadnall

Shrewsbury

Shropshire

SY4 4AS

United Kingdom

Tel: +44 (0) 1939 211200

**17. Other information**

POM-V

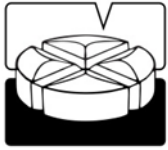

Divisible tablet

*Gavin Hall*  
Approved: 17 January 2025