

**PARTICULARS TO APPEAR ON THE OUTER PACKAGE {CARTON}**

**1. NAME OF THE VETERINARY MEDICINAL PRODUCT**

Canergy 100 mg tablets

**2. STATEMENT OF ACTIVE SUBSTANCES**

Each tablet contains:

**Active substance:**

Propentofylline 100 mg

**3. PACKAGE SIZE**

10, 20, 30, 40, 50, 60, 70, 80, 90, 100, 250, 500 tablets

**4. TARGET SPECIES**

Dogs

**5. INDICATIONS**

**6. ROUTES OF ADMINISTRATION**

Oral use.

**7. WITHDRAWAL PERIODS**

**8. EXPIRY DATE**

Exp. {mm/yyyy}

Shelf life of divided tablets after first opening the immediate packaging: 4 days.

**9. SPECIAL STORAGE PRECAUTIONS**

Any unused tablet portion should be returned to the open blister and inserted back into the carton to be used for the next administration.

**10. THE WORDS “READ THE PACKAGE LEAFLET BEFORE USE”**

Read the package leaflet before use.

**11. THE WORDS “FOR ANIMAL TREATMENT ONLY”**

For animal treatment only.

**12. THE WORDS “KEEP OUT OF THE SIGHT AND REACH OF CHILDREN”**

Keep out of the sight and reach of children.

**13. NAME OF THE MARKETING AUTHORISATION HOLDER**

Le Vet Beheer B.V.

**14. MARKETING AUTHORISATION NUMBERS**

Vm 41821/4019

**15. BATCH NUMBER**

Lot {number}

**MINIMUM PARTICULARS TO APPEAR ON SMALL IMMEDIATE PACKAGING  
UNITS { Aiu- PA/Aiu/PVC BLISTER}**

**1. NAME OF THE VETERINARY MEDICINAL PRODUCT**

Canergy

**2. QUANTITATIVE PARTICULARS OF THE ACTIVE SUBSTANCES**

100 mg propentofylline / tablet

**3. BATCH NUMBER**

Lot {number}

**4. EXPIRY DATE**

Exp. {mm/yyyy}

Shelf life of divided tablets after first opening the immediate packaging: 4 days.

**PARTICULARS TO APPEAR ON THE PACKAGE LEAFLET:**

**PACKAGE LEAFLET**

**1. Name of the veterinary medicinal product**

Canergy 100 mg tablets for dogs

**2. Composition**

Each tablet contains:

**Active substance:**

Propentofylline                      100 mg

Light brown with brown spots, round and convex flavoured tablet with a cross-shaped break line on one side.

The tablets can be divided into 2 or 4 equal parts.

**3. Target species**

Dogs.

**4. Indications for use**

For the improvement of peripheral and cerebral vascular blood circulation. For improvement in dullness, lethargy and overall demeanour in dogs.

**5. Contraindications**

Do not use in dogs weighing less than 5 kg.

Do not use in cases of hypersensitivity to the active substance or to any of the excipients.

Please also see the section on use during pregnancy and lactation.

**6. Special warnings**

Special warnings:

None.

Special precautions for safe use in the target species:

Specific diseases (e.g. kidney disease) should be treated accordingly.

Consideration should be given to rationalising the medication of dogs already receiving treatment for congestive heart failure or bronchial disease.

In the case of renal failure, the dose should be reduced.

The tablets are flavoured. In order to avoid any accidental ingestion, store tablets out of reach of the animals.

Special precautions to be taken by the person administering the veterinary medicinal product to animals:

Care should be taken to avoid accidental ingestion.

In case of accidental ingestion, seek medical advice immediately and show the package leaflet or the label to the physician. Wash hands after use.

Any unused tablet portion should be returned to the open blister and inserted back into the carton to be used for the next administration.

Pregnancy and lactation:

The safety of the veterinary medicinal product has not been established during pregnancy and/or lactation. The use in pregnant or lactating bitches or breeding animals is not recommended.

Interaction with other medicinal products and other forms of interaction:

None known.

Overdose:

Excitation tachycardia, hypotension, reddening of mucous membranes and vomiting. The withdrawal of the treatment leads to a spontaneous remission of these signs.

**7. Adverse events**

Dogs:

Rare (1 to 10 animals / 10,000 animals treated):	Allergic skin reaction <sup>a</sup> Cardiac disorder <sup>a</sup> Vomiting <sup>a</sup>
---	---

<sup>a</sup> In these cases the treatment should be stopped.

Reporting adverse events is important. It allows continuous safety monitoring of a product. If you notice any side effects, even those not already listed in this package leaflet, or you think that the medicine has not worked, please contact, in the first instance, your veterinarian. You can also report any adverse events to the marketing authorisation holder or the local representative of the marketing authorisation holder using the contact details at the end of this leaflet, or via your national reporting system at:

Website: <https://www.gov.uk/report-veterinary-medicine-problem/animal-reacts-medicine>

e-mail: [adverse.events@vmd.gov.uk](mailto:adverse.events@vmd.gov.uk)

**8. Dosage for each species, routes and method of administration**

For oral use.

The basic dosage is 6 - 10 mg propentofylline per kg bodyweight daily, divided into two doses as follows:

100 mg Tablets				
Body weight (kg)	Morning	Evening	Daily total tablets	Daily total dose (mg/kg)
5 kg – 8 kg	☐	☐	½	6.25 – 10.0
>8 kg – 10 kg	☐	☐	¾	7.5 – 9.4
>10 kg – 15 kg	☐	☐	1	6.7 – 10.0
>15 kg – 25 kg	☐	☐	1 ½	6.0 – 10.0
>25 kg – 33 kg	⊕	⊕	2	6.1 – 8.0
>33 kg – 49 kg	⊕ ☐	⊕ ☐	3	6.1 – 9.1
>49 kg – 66 kg	⊕ ⊕	⊕ ⊕	4	6.1 – 8.2
>66 kg – 83 kg	⊕ ⊕ ☐	⊕ ⊕ ☐	5	6.0 – 7.6

☐ = ¼ Tablet      ☐ = ½ Tablet      ☐ = ¾ Tablet      ⊕ = 1 Tablet

### 9. Advice on correct administration

To ensure a correct dosage, body weight should be determined as accurately as possible before treatment. The tablets can be administered directly in the mouth, onto the back of the dog's tongue or can be mixed in a small ball of food and should be administered at least 30 minutes before feeding.

Tablets can be divided into 2 or 4 equal parts to ensure accurate dosing. Place the tablet on a flat surface, with its scored side facing up and the convex (rounded) side facing the surface.

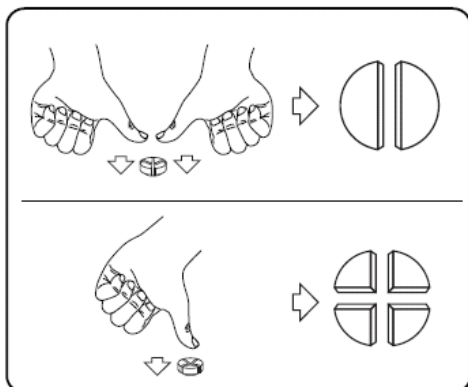

Halves: press down with your thumbs on both sides of the tablet.  
 Quarters: press down with your thumb in the middle of the tablet.

### 10. Withdrawal periods

Not applicable.

## **11. Special storage precautions**

Keep out of the sight and reach of children.

Shelf life of divided tablets after first opening the immediate packaging: 4 days.

This veterinary medicinal product does not require any special temperature storage conditions.

Any unused tablet portion should be returned to the open blister and inserted back into the carton to be used for the next administration.

Do not use this veterinary medicinal product after the expiry date which is stated on the carton and the blister after Exp. The expiry date refers to the last day of that month.

## **12. Special precautions for disposal**

Medicines should not be disposed of via wastewater.

Use take-back schemes for the disposal of any unused veterinary medicinal product or waste materials derived thereof in accordance with local requirements and with any applicable national collection systems. These measures should help to protect the environment.

Ask your veterinary surgeon or pharmacist how to dispose of medicines no longer required.

## **13. Classification of veterinary medicinal products**

Veterinary medicinal product subject to prescription.

## **14. MARKETING AUTHORISATION NUMBERS AND PACK SIZES**

Vm 41821/4019

Aluminium - PA/ALU/PVC blister

Cardboard box of 1, 2, 3, 4, 5, 6, 7, 8, 9, 10, 25 or 50 blisters of 10 tablets

Not all pack sizes may be marketed.

## **15. PID LINK (Do not print heading)**

*[The following statement must be included where reference to the European Union Product Database is included on the product information. This statement is relevant to both UK(GB) and UK(NI) products:]*

Find more product information by searching for the 'Product Information Database' on [www.gov.uk](http://www.gov.uk).

## **16. Contact details**

Marketing authorisation holder:

Le Vet Beheer B.V.

Wilgenweg 7

3421 TV Oudewater

The Netherlands

Manufacturer responsible for batch release:

Artesan Pharma GmbH & Co KG  
Wendlandstrasse 1  
29439 Lüchow  
Germany

Lelypharma B.V.  
Zuiveringweg 42  
8243 PZ Lelystad  
The Netherlands

Genera d.d.  
Svetonedeljska cesta 2, Kalinovica  
10436 Rakov Potok  
Croatia

Local representatives and contact details to report suspected adverse reactions:

Dechra Veterinary Products Limited  
Sansaw Business Park  
Hadnall  
Shrewsbury  
Shropshire  
SY4 4AS  
United Kingdom  
Tel: +44 (0) 1939 211200

For any information about this veterinary medicinal product, please contact the local representative of the marketing authorisation holder.

**17. Other information**

POM-V

*Gavin Hall*

Approved: 01 May 2026